



**Sure Glow™
Audio Monitor
2 Receiver Set**

Thank you for purchasing a Safety 1st product. We are not only about safety, we're also about your satisfaction. If you have any questions or comments, please call our Consumer Relations department at 1-800-544-1108 or e-mail us at consumer@safety1st.com

Please read the following instructions and warnings carefully. Keep these instructions for future reference.
Tool needed: Phillips Head Screwdriver (not included)

WARNING!
STRANGULATION HAZARD! Children have **STRANGLED** in cords. NEVER place cords within 6 feet of the crib. Do not use with extension cord. Only use the AC adapters provided.

Features & Components

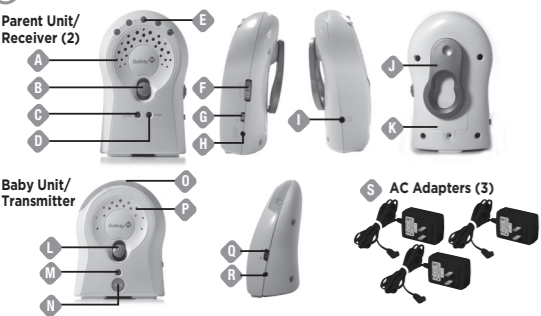

- Parent Unit (2 Receivers)**
- A Speaker
 - B Power/1 & 2 Channel Switch
 - C Low Battery Indicator
 - D Power On Indicator
 - E Sound Lights (5 LEDs)
 - F Volume Dial
 - G Channel Select Button (A/B)
 - H AC Adapter Jack
 - I External Earphone Jack
 - J Belt Clip & Carry Loop
 - K Battery Compartment (3 AAA batteries)
- Baby Unit (Transmitter)**
- L Power/1 & 2 Channel Switch
 - M Power On Indicator
 - N Pager Button
 - O Night Light Activation
 - P Microphone
 - Q Channel Select Button (A/B)
 - R AC Adapter Jack
- AC Adapter**
- S AC Adapter (3)

Battery Installation & Use

- CAUTION!**
- DO NOT mix old and new batteries.
 - DO NOT mix alkaline, standard (carbon zinc), or rechargeable (nickel-cadmium) batteries.
 - Only batteries of the same or equivalent type as recommended are to be used.
 - Exhausted batteries are to be removed from the unit.
 - Keep batteries out of child's reach. Swallowing a battery could be fatal.
 - Used batteries should be disposed of properly. Do not dispose of batteries in fire - they may explode or leak and cause injury.
 - Remove batteries when stored for long periods of non-use.
 - DO NOT use audio monitor system in portable mode when batteries are low.
 - Ensure that the battery compartment is completely secure after replacing batteries.



BATTERY INSTALLATION:

1. Move belt clip out of way. Unscrew battery compartment cover as shown.
2. Insert 3 AAA batteries.
3. Replace the battery compartment cover and tighten screw. To obtain maximum performance, ALWAYS use alkaline type batteries in this monitor.



Safety Instructions

- IMPORTANT:**
- Parent Unit is a Receiver. Baby Unit is a Transmitter.
 - Check the reception regularly.
 - Certain electronic devices are sensitive to magnetic fields and may be damaged permanently or temporarily disabled if exposed to a magnetic field that is too strong.
 - To remove AC adapter from the outlet, firmly grasp the adapter "brick." DO NOT pull on the cord, as this could damage it.
 - The LEDs emit IR (infra red) light that is not harmful.

WARNING!
For indoor use only. To reduce the risk of fire or electrical shock, do not expose this product to water or moisture. NEVER attempt to disassemble the product. This is dangerous and will void the warranty.

CAUTION!
This monitor is not intended to be used as a medical monitor and its use should not replace proper adult supervision. You should check your child's activity at regular intervals as this monitor will not alert parents to the silent activities of a child.

It is essential to check reception regularly. Please see Use and Care section.

VENTILATION: The Monitor should not be situated on a bed, sofa, rug, or similar surface that may block the ventilation openings, or placed in an enclosed installation, such as a book case or cabinet that may impede the flow of air through the ventilation openings.

- Position the Transmitter, Receiver and AC adapters to allow adequate ventilation and prevent these components from overheating.

HEAT: The Monitor should be situated away from heat sources such as radiators, heat registers, stoves, or other appliances that produce heat. Also keep these components out of direct sunlight.

POWER SOURCE: The Monitor should be connected to a power supply only of the type described in these operating instructions.

POWER CORD PROTECTION: The power supply cord should be routed so that it is not likely to be walked on or pinched by items placed upon or against it. Pay particular attention to the cord at the plug, convenience receptacle, and at the point it exits from the Monitor. **NOTE: Do not place adapter under a window where a child might use it to step on and reach something that might be dangerous.**

- Check to make sure outlet plates are not unusually hot to the touch. If they are, immediately unplug cords from these outlets. Check that all outlet connections are in good condition so that adapter is not loose or that no wiring is exposed. Have a qualified, licensed electrician check the wiring as soon as possible.

OBJECT AND LIQUID ENTRY: Care should be taken so that objects do not fall onto, and liquids are not spilled into the enclosure through the openings.

DAMAGE REQUIRING SERVICE: The Monitor should be serviced by qualified service personnel when:

- A. The power supply cord has been damaged; or
- B. Objects have fallen or liquid has been spilled into the product; or
- C. The Monitor has been exposed to rain; or
- D. The Monitor does not appear to operate normally or exhibits a marked change in its performance; or
- E. The Monitor has been dropped or the enclosure damaged.

THE USER SHOULD NOT ATTEMPT TO SERVICE OR REPAIR THE MONITOR. ALL SERVICING SHOULD BE REFERRED TO SAFETY 1ST CUSTOMER SERVICE DEPARTMENT: (800) 544-1108.

Quick Start Guide

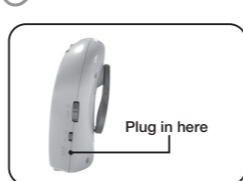

1 Connect AC adapter to the side of Parent Unit.

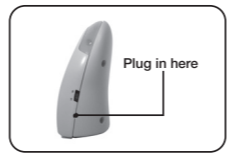

3 Connect AC adapter to the side of Baby Unit.



5 Turn Parent Unit on. Slide Power/Channel switch to desired channel selection on front and side A/B button. Power On Indicator will illuminate. Make sure volume is turned down to avoid squealing.

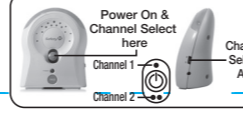

6 Turn Baby Unit on. Slide Power/Channel switch to desired channel selection on front and side A/B button. Refer to Channel Selection section. Power On Indicator will illuminate.

WARNING!
STRANGULATION HAZARD! Children have **STRANGLED** in cords. NEVER place cords within 6 feet of the crib. Do not use with extension cord. Only use the AC adapters provided.



4 Plug Parent Unit and plug Baby Unit into wall to operate AC power.

Using Your Monitor

DO NOT PLACE UNIT IN CRIB OR MOUNT ON CRIB. KEEP OUT OF REACH OF CHILDREN.

AC ADAPTER

The Parent Unit operates on household electricity with the AC Adapter or with 3 AAA batteries (not included). The Baby Unit operates on household electricity with the AC Adapter only. The Parent Unit will automatically convert to AC operation when used with the AC Adapter. It is not necessary to remove the battery during AC operation. The Parent Unit will automatically switch back to battery power when plug is disconnected from the AC Adapter.

The AC Adapter should be used whenever possible on the Parent Unit to save battery life. This is done by inserting the AC Adapter into the AC Adapter Jack. Then simply plug the AC Adapter into a nearby standard household outlet (120V AC outlet). The AC Adapters may become slightly warm to the touch during operation. This is normal.

This AC Adapter is a low voltage power source which allows you to use your household electricity to run the Baby and Parent Units when it connects to the AC Adapter Jack in the Parent Unit and in the Baby Unit, and plugs into any standard electrical outlet in your home.

To remove AC adapter from the outlet, firmly grasp the adapter "brick." DO NOT pull on the cord, as this could damage it.

CAUTION: This AC Adapter was made with a specific design for the Safety 1st Monitor. It cannot be used with any other appliance, and never use a different type of adapter with this Monitor.

Parent Unit (Receiver):

CHANNEL SELECTION

The Monitor can broadcast over four preset factory frequencies or channels. Use setting "1A" making sure that both units are set to "1A". If you experience static or noise interference, simply switch both units to channel "1B", "2A" or "2B", whichever channel option provides the best reception.

POWER INDICATOR

The power indicator is a green LED that indicates that the unit is on and functioning.

VOLUME DIAL

Volume can be justed to any desired listening level by rotating the Volume Dial, so you can be sure to hear your baby at all times. The sounds are transmitted through the wide range speaker. It is essential to check reception regularly. Refer to Use and Care section.

SOUND LIGHTS

As baby's voice gets louder, the sound light LEDs will illuminate from left to right. Low sound is one LED illuminated and rises incrementally as baby's noise level increases until all 5 LEDs are illuminated.

LOW BATTERY INDICATOR

Low battery power is indicated by the red LED, which signals when the battery needs to be replaced.

EARPHONE JACK

Earphones (not included) can be plugged into earphone jack on side of Parent Unit. When earphones are in place, it will mute the speaker.

LINK INDICATOR - OUT OF RANGE

Static noise will be heard if both units are not set to the same channels or if they are too far apart.

BELT CLIP

The Belt Clip is convenient for portability. You can clip the Parent Unit to your belt or waistband after a battery has been installed. The Belt Clip also easily converts to a carry loop.



Using Your Monitor (continued)

Baby Unit (Transmitter):

PROPER POSITIONING

IMPORTANT: When choosing locations to set up the Baby Unit and Parent Unit, follow these guidelines:

- For best sound quality, place Baby Unit 6 feet (2 meters) away from the baby.
- Adjust volume dial on Parent Unit to appropriate level to minimize feedback.
- During use of the monitor, sound quality deteriorates as you reach the limits of the monitor's range. If this happens, you will need to move the Parent Unit in closer proximity to the Baby Unit.
- Adjust the volume to a comfortable level for your environment.

FREQUENCY RANGE

Channel 1A Frequency: 49.850 Channel 1B Frequency: 49.830
Channel 2A Frequency: 49.870 Channel 2B Frequency: 49.890
Carrier Frequency: 49.830 to 49.890
Field Strength is 80 dB Micro-volts per meter at 3 meters.

NIGHT LIGHT

Activate the night light by pressing on the top of the Baby Unit, which will activate a switch located on the bottom of Baby Unit. Night light will remain on until you press the top of the Baby Unit again.

PAGER

The Pager Button is helpful to locate a misplaced Parent Unit. With the Baby Unit on, press the pager button on the front of the Baby Unit. Parent Unit must be on and volume must be elevated to hear pager beep. Pager will send out a beep to the Parent Unit for 60 seconds. NOTE: The Parent Unit will only beep if it is powered on.

Use and Care

IMPORTANT:

The first time you use your monitoring system, two adults should test it in the following way:

- Place Parent Unit at least 20 ft. (6m) away from Baby Unit.
- Have an adult speak into Baby Unit at various levels (soft to loud) while another adult checks Parent Unit for the proper sound reception.

Try Parent Unit in every location that it will be used.

Troubleshooting

IF YOU ARE STILL HAVING PROBLEMS, PLEASE CALL TOLL FREE FOR HELP! (800) 544-1108.

PROBLEM	POSSIBLE CAUSE	SOLUTION
Power indicator light not working	Power is not getting to the Unit	Make sure wall outlet is working; may possibly need to be turned on by a switch Make sure AC adapter is plugged into wall and the Unit
Static or interference in the signal transmission	Baby and Parent Units may be on different channels Appliances with loud fans near Units may be blocking transmission Unit may be under fluorescent lights Local interference from electrical or radio frequency appliance near your location	Make sure both Units are on the same channel (4 channel options: 1A, 1B, 2A or 2B) Turn off the appliances that may be causing interference Reduce the distance between the two Units or turn off lights Switch channel setting on both Parent and Baby Units
Parent Unit is making loud noises	Units are too close together Volume dial on Parent Unit may be too high	Parent Unit needs to be at least 10 feet / 3 meters away from the Baby Unit Turn down volume on the Parent Unit
Parent Unit is picking up noises from outside your home	Neighbors may have a baby monitor or cordless phone	Change both Units to the alternative channel (4 channel options: 1A, 1B, 2A or 2B)
Weak sound coming from Parent Unit	Battery may be weak Units may be too far away from each other	Check battery; replace if necessary Move the Units closer to each other

FCC Statement

Radio Interference

Note: This equipment has been tested and found to comply with the limits for a class B digital device, pursuant to part 15 of the FCC Rules and applicable Industry Canada specifications. These Limits are designed to provide reasonable protection against harmful interference in a residential installation. For body worn operation, this product has been tested and meets the FCC RF exposure guidelines when used with the belt clip supplied or designed with this product. Use of other accessories may not ensure compliance with the FCC exposure guidelines.

This device complies with part 15 of the FCC Rules. Operation is subject to the following two conditions: (1) this device may not cause harmful interference, and (2) this device must accept any interference received, including interference that may cause undesired operation.

This equipment generates, uses and can radiate radio frequency energy and, if not installed and used in accordance with the instructions, may cause harmful interference to radio or television reception, which can be determined by turning this equipment off and on, the user is encouraged to try to correct the interference by one or more of the following measures:

- Reorient or relocate the receiving antenna
- Increase the separation between the equipment and the receiver
- Connect the equipment into an outlet on a circuit different from that to which the receiver is connected.
- Consult the dealer or an experienced radio/TV technician for help.

To operate this equipment under the Federal Communications Commission rules.

WARNING: Changes or modifications not expressly approved by Dorel Juvenile Group can void your authority to operate this equipment.

This Category II radiocommunication device complies with Industry Canada Standard RSS-310.

Ce dispositif de radiocommunication de catégorie II respecte la norme CNR-310 d'Industrie Canada.

Helpful Hints

Use household electricity whenever possible. When the AC Adapter is used with your household electricity, you will find that the power is stronger and more consistent than when you rely solely on the battery. Range and sound quality also depends on the construction of your house. Steel reinforced wall, for example, reduces the effective range of the monitor. Conserve the battery so you will have power when you don't have easy access to AC outlets.

Make sure that both Units are on the same channel.

Even though you may hear your baby's sounds, proper use of this system requires that both Units must be on the same channel. If the Units are on different channels, the signals from the Baby Unit may still be strong enough to be picked up by the Parent Unit, but there will be a lot of static.

When not using the Unit, remove AC Adapter and be sure the power button is "OFF".

When you are not using the AC Adapter, remove it from the Unit and store it in a safe, dry place until you need it again. If the AC Adapter is plugged into the Parent Unit but not being used in an electrical outlet, the AC Adapter will prevent battery operation of the Unit.

When using the AC Adapter with household electricity, make sure the outlet is "ON".

Some electrical outlets are powered through a switch in the room. If the Baby Unit is plugged in and turned "ON", the power indicator light should be lit. If it is not, try turning the light switch in the room "ON".

Care and Cleaning:

Use a soft, dry cloth to keep your monitor free from dust. DO NOT immerse product in water.

One (1) Year Limited Warranty

Dorel Juvenile Group, Inc. warrants to the original purchaser that this Sure Glow™ Audio Monitor 2 Receiver Set, is free from material and workmanship defects when used under normal conditions for a period of one (1) year from the date of purchase. Should the product contain defects in material or workmanship Dorel Juvenile Group, Inc., will repair or replace the product, at our option, free of charge. Purchaser will be responsible for all costs associated with packaging and shipping the product to Dorel Juvenile Group Consumer Relations Department at the address noted below and all other freight or insurance costs associated with the return. Dorel Juvenile group will bear the cost of shipping the repaired or replaced product to the purchaser. Product should be returned in its original package accompanied by a proof of purchase, either a sales receipt or other proof that the product is within the warranty period. This warranty is void if the owner repairs or modifies the product or the product has been damaged as a result of misuse.

This warranty excludes any liability other than that express stated previously, including but not limited to, and incidental or inconsequential damages.

SOME STATES DO NOT ALLOW THE EXCLUSION OR LIMITATION OF INCIDENTAL OR CONSEQUENTIAL DAMAGES, SO THE ABOVE LIMITATION OR EXCLUSION MAY NOT APPLY TO YOU. THIS WARRANTY GIVES YOU SPECIFIC LEGAL RIGHTS, AND YOU MAY ALSO HAVE OTHER RIGHTS THAT MAY VARY FROM STATE TO STATE.

Thank you again for purchasing a Safety 1st product. We are not only about safety, we're also about your satisfaction. If you have any questions or comments, please call our Consumer Relations department at 1-800-544-1108 or e-mail us at consumer@safety1st.com.